



EN

As one of the leader companies in the production and marketing of solid wood, Salkim Forest Products owns various production facilities equipped with advanced technology both in Turkey and abroad. Salkim has been rendering service at its sales points located in Romania, Morocco and Uzbekistan in addition to its stores extended nationwide. Our Demirköy (Central) factory is established over a total area of 125.000 m² , including a covered area of 30.000 m², and has beech (fagus sylvatica) and oak (Quercus Patrea, Robur) timber production capacity amounting to 150.000 m³ per year.

We have 2.000 m³ hardwood timber kiln drying capacity and 4.000 m³ beech timber steaming capacities per month. Our annual oak and beech edge glued solidwood panel production capacity is 13.500 m³. Our İstanbul factory is located over a covered area of 10.000 m², where 6.000 m³ of pine and spruce edge glued solidwood panel production is available. Besides, serial production line of packed DIY furniture serves the Home Improvement retail chains in Turkey and abroad.

Focusing on customer satisfaction and raw material quality, advanced technological investments, rapid and effective distribution of our products play important role for the development of our company. Edge Glued Solidwood panels are the main products of our company. These panels are produced through very sensitive processes and their use in everyday life is increasing day by day. Besides the production of solidwood panels, we also produce Tongue & Grooved flooring, decking, paneling, timber and wooden railway sleepers.

Salkim Forest Products, with its modern production facilities, technological equipment, expert production and marketing staff, offers professional solutions to fulfill all your requirements for solid wood products.





Our duty is to bring together the human and tree...

Tree is the cradle of our children, the house which we live in, the pencil which we are writing our story with, the oxygen we breathe and the coffin we will be buried with.

Tree is the witness of our life from birth to death.

We know that; the human- tree relation will never end. Our journey with trees will continue from the door sill of our homes to the cradle of our babies.

because it is good for us.

**It gives us health and pleasure to walk on it,
to touch it, to see it in all fields of life.**

Our Products

- EGP SOLIDWOOD PANEL •TIMBER •WOODEN RAILWAY SLEEPERS
- T&G FLOORING •LAMINATED PARQUET •DECKING •PANELING
- LAMINATED BEAM •WOOD PROFILE •OSB •PLYWOOD





Where are we located?

Head Office / TURKEY

Başakşehir / İSTANBUL

İ.O.S.B. Keresteciler Sitesi
19. Sok. 20. Blok No:22-24
Tel: +90 212 670 49 31
info@salkimorman.com.tr

Factories / TURKEY

Demirköy / KIRKLARELİ

Yeni Mahalle Fidanlık Cad. No: 2/B

Küçükçekmece / İSTANBUL

Mehmet Akif Mah. Bahariye Cad. No: 161 A

Morocco Factory

Azib Abakiou, km1, Mghogha, Route
De Tetouan, Ancien Maison Daica
Tanger 90000

Bulgaria Factory

Georgi Dimitrov Caddesi No 3
Manolich Sungurlare Burgas

Uzbekistan Factory

Almazar Region, Usta Shirin
Street No: 132 Tashkent

Ukraine Factory

Puşkin Bulvarı No: 23 Natalivka,
Novograd Volyinski

Romania Store

Voluntari, Bucharest

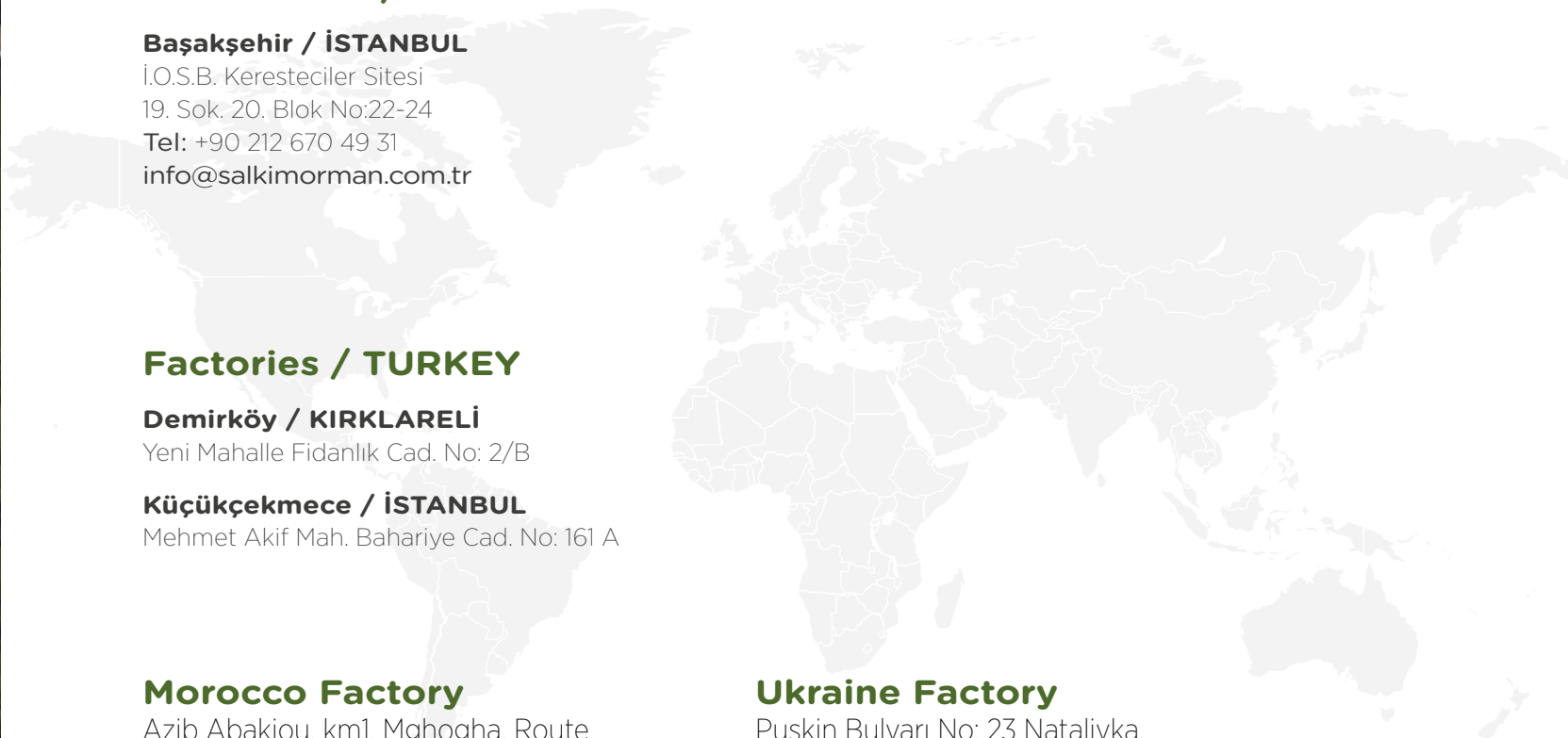



Wood is produced by water, sun, soil and air, not by the chemicals...

As the concept of “life in harmony with the environment” is increasing, the importance of wood which is an environmentally friendly material has been constantly increasing. Despite experiencing lower demand during periods of new material introduction to market, wood regained its popularity in recent times due to its renewable and environmentally friendly nature. Most important reasons of this popularity are; its natural texture, the aesthetic and visual value it adds to the space and its reliability as a structural material. As wood is a natural, sustainable, renewable and lighter building material which is also resistant to earthquake and fire, recently it has become the material of choice by the architects, civil engineers and conscious consumers.

About wood...

Wood; is one of the first things that spring to mind and one of the most commonly used materials when natural, renewable building materials are referred to. It is a naturally sourced, renewable, sustainable, reusable, environmentally friendly material which does not lead to waste. In addition to all of these, wood is a perfect engineering material.





Sustainability

In order to protect the forest which is the witness of our entire life and in line with our sustainability principles, we are acting with the responsibility of getting together the wood and human in the most fair and proper manner and we have been returning to the nature the same number of trees which we had taken from it. We hold the International FSC® (FOREST Stewardship Council®) Certificate, which aims to specify relevant standards for the accurate use of forestry products.

Because we know that as long as the trees exist, we will exist. We know that we can only survive when the trees are alive. So we return to the forest what we have taken from it. While we continue to introduce you with our planet's most natural and healthy material, we shall also continue to plant tens of thousands of saplings with the nature every year. We shall continue to return what we have taken from the nature and we shall continue to be a role model without compromising our principles of sustainability and understanding of nature.



The mark of
responsible forestry

Respect to the forest, respect to human: FSC®

FSC® is stakeholder's system aiming to manage the world forests in the best manner, to assist the management of forestry in accordance with sustainable forest management principles, to provide the protection of forest areas and maintain their permanent existence, to provide these applications on international ground. The purpose of the forestry management which complies with environmental conditions is that the timber and other forest products should be obtained without harming the forest's biological diversity and productivity as well as the ecologic processes thereof.

The purpose of the forest management which provides important benefits in terms of social aspects is that; we should establish the systems which the local people and society will benefit from the forest and forestry products in the long term provided that they should also attend long term management plans which supports the sustainable use of these sources. The management of the forest which creates economic gain is that all interventions on the forests should be maintained, by seeking profit, without deteriorating the ecosystem and the social balance. For the accomplishment of these goals various international standards have been determined.

Edge Glued Solidwood Panel

- 100% Natural
- Robust and decorative
- Long-lasting
- Provides savings in labor, time and materials
- Side band and covering cost eliminated
- The adhesive used is an environment-friendly material

TECHNICAL PROPERTIES

Adhesive: D3 - D4

Moisture: %10 ± 2

Surface: 120 Sand (Both Surfaces)

Lamella: Continuous Lamella (Solid) –
Finger Jointed Lamella (FJ)

Quality: A/A, A/B, B/B, C/C

Thickness (mm): 16-18-22-25-30-40

Width (mm): 650-700-800-1.000-1.220

Length (mm): 3.000-3.500-4.000-4.100

Custom sizes available.

(5000 mm Maximum Length)

Solidwood Panel Production

Salkim Forest Products initiates the solidwood panel production process in the forest. Log procurement is accomplished by our expert team. The logs are supplied from our country's FSC® certified forests and are checked one by one, later on they are shipped to our factories.



In order to provide forest sustainability, Salkim Wood Panels are produced from trees that have come to end of its life. Sound and healthy logs, which are procured from Turkey and abroad, are processed at our high capacity and advanced technology factories, into timber. Timber is dried in our automatic kilns to the proper humidity rate and then turned into solid panels by our experienced team adhering to international quality standards.

Finger jointed and full-size lamellas are dimensioned in requested sizes and standards and brought ready for pressing. Lamellas which have been separately classified as finger jointed and full stave lamellas are glued from the sides and pressed side by side. Panels are then cut into specified sizes and calibration and sanding is applied on both surfaces. Solidwood panels are protected from external factors by a shrink wrap as they are natural wood in structure.

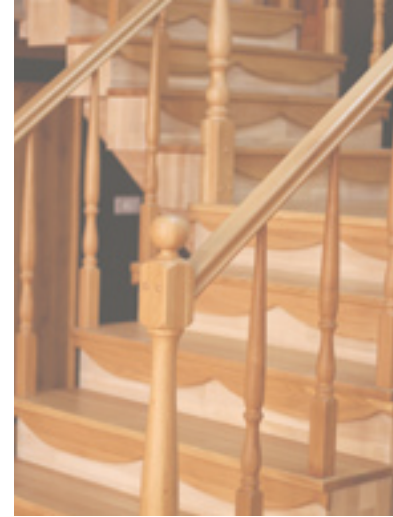

Decorative appearance



Areas of Use of Solidwood Panels

Solidwood panels are used for the manufacturing of all kinds of wooden furniture and chairs, stairs, architectural projects and exhibition booth applications, home, office and store decorations, school furnitures and coffins, wall cladding and flooring, base, ceiling and interim partitions, yacht deck and cabin decoration.

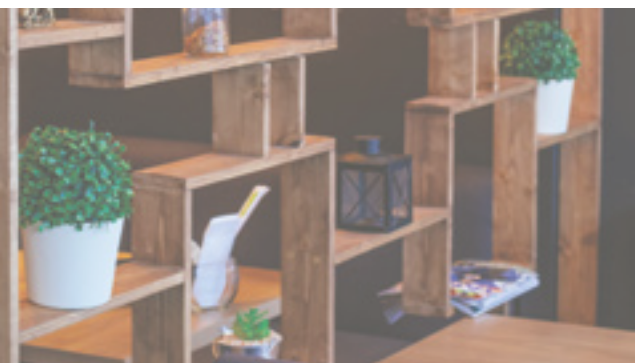

Firm, long-lasting



Ready for direct use

Wide range of usage



Oak

Solidwood Panel

Oak solidwood panels are completely produced from domestic Istranca oaks. Istranca region is the place where the hardest, top quality and long-lasting oaks are raised in our country. Istranca oak is in goldish color and has a very firm texture and it is a different type among other oaks. Its specific weight is 860 kg/m³ approximately.



Areas of Use

Oak is mainly used for the internal and external sections of the buildings, door, window, stairs, floor covering and manufacturing of parquet. Suitable for holders, barrel, wagon, car, vessel, boat, deck applications, bridge and pier legs and railway infrastructure as well. Oak is used for furniture production, inner parts of the buildings, decoration applications.



Oak FJ A
Solidwood Panel



Oak FJ B
Solidwood Panel



Oak FJ B+
Solidwood Panel



Oak FJ B-
Solidwood Panel



Oak FJ C
Solidwood Panel



Oak Solid A
Solidwood Panel



Oak Solid B
Solidwood Panel



Oak Rustik
Solidwood Panel

Beech

Solidwood
Panel

Sapwood has reddish white color while heartwood is reddish brown. It has long life and is durable thanks to its rigid texture. Processing characteristics may change depending on growing conditions and humidity. It can be processed in machinery and using hand tools. It is very suitable for turning, and is made very long lasting and durable by steaming. Beech bonds well, responds well to polishing and it is suitable for painting. Average specific weight is 675 kg/m³.



Areas of Use

It has wider area of use than the other leaved trees. Especially used for the production of solid furniture, school desk, wainscot, sport tools, toys, tool handles, lathing, music instruments, plywood, parquet, board lining, barrels and mostly in stairs production.

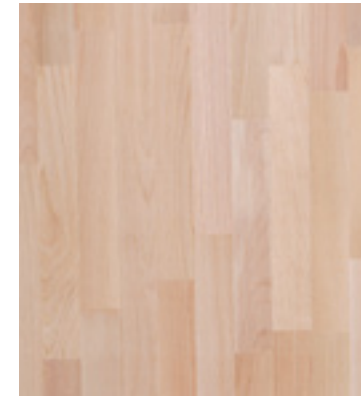

Beech FJ A
Solidwood Panel



Beech FJ B
Solidwood Panel



Beech FJ B+
Solidwood Panel



Beech Solid A
Solidwood Panel



Beech Solid B
Solidwood Panel

Pine

Solidwood Panel

Sapwood is in yellowish and reddish white color, heartwood is in reddish yellow, brownish red color, becoming darker in time. It can be dried quickly and well. It can be processed easily, bonds well, have good flexibility, suitable for painting, polishing, turning, stripping, holds nails well and can be painted. Average specific weight is 500 kg/m³.



Areas of Use

Stairs, doors, windows, joineries of structures, interior – exterior facade coating (panel) and floor furnishing (deck, tiling); ship board tiling, carving and turning.



Pine FJ A
Solidwood Panel



Pine FJ ABM
Solidwood Panel



Pine FJ B
Solidwood Panel



Pine FJ C
Solidwood Panel



Pine Solid A
Solidwood Panel



Pine Solid B
Solidwood Panel

Spruce Solidwood Panel

Sapwood and Heartwood are the same in color. Core section has mature wood characteristics and has yellowish white color. It is easily processed, stripped, and has good nail and screw insertion attributes. It bonds well and can be painted. Responds well to painting and polishing. It can be quickly and well dried, has low cracking tendency. It has a uniform texture, regular and easy to split fibers. Average specific weight is 450 kg/m³.



Areas of Use

Generally used in carpentry works and joineries, making of boxes and chests, musical instruments, toddler and any type of solid furniture.

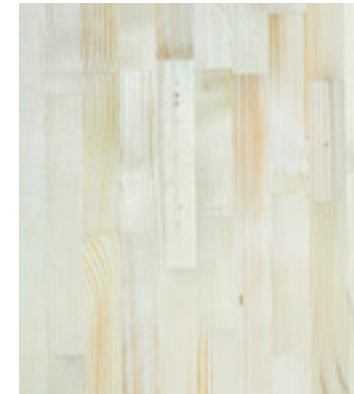

Spruce FJ A
Solidwood Panel



Spruce FJ B
Solidwood Panel

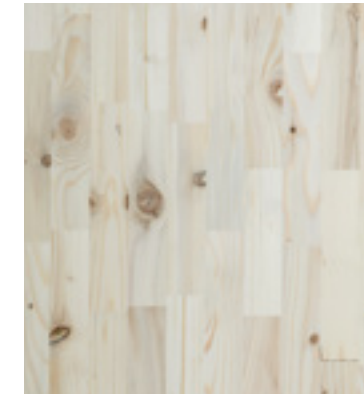

Spruce FJ B-
Solidwood Panel

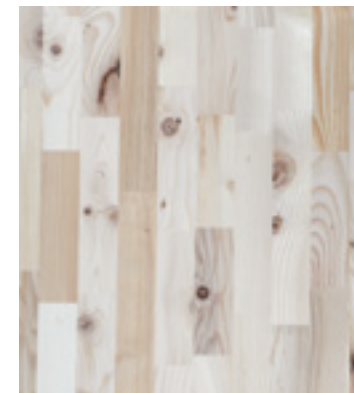

Spruce FJ C
Solidwood Panel



Spruce Solid A
Solidwood Panel

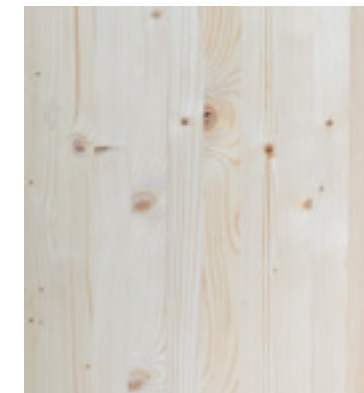

Spruce Solid B
Solidwood Panel

Iroko

Solidwood
Panel

The color turns from yellow to dark brown in time. It is an exotic, kiln-dried wood imported from Africa. Iroko wood is particularly preferred for outdoor use thanks to its hardness.



Areas of Use

Iroko is a very decorative, long lasting tree used in outdoor applications, floor furnishings, outdoor furniture and boats which require durability and long life.



Iroko FJ A
Solidwood Panel

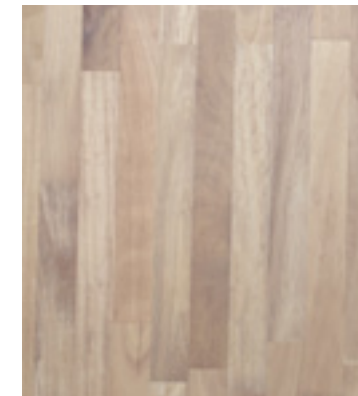

Iroko Solid B
Solidwood Panel



Iroko Solid Antique
Solidwood Panel

Sapelli

Solidwood
Panel

Sapwood color is gray. Heartwood color varies between yellow and reddish brown depending on the type. The color revealed at the time of cutting darkens to a certain extent in time with exposure to atmosphere.



Areas of Use

It is a tree with superior qualities, and can be used for diverse purposes. It has a wide area of use including interior and exterior sections of structures, joineries, hardwood floor, stairs, ship construction, musical instruments, turnery, carving, damask works, modern and classical furniture in solid form or as coating.



Sapele FJ A
Solidwood Panel



Sapele FJ B
Solidwood Panel



Sapele Solid A
Solidwood Panel



Sapele Solid B
Solidwood Panel

Walnut

Solidwood
Panel

In Europe, Turkey and Southwestern Asia, walnut sapwood is in grayish white and reddish white color, while heartwood color depends on age and growing location, and can be in gray and dark brown color and may have dark stripes. Heartwood has medium resistance.



Areas of Use

The most suitable wooden material for high quality furniture production in solid and coating panel forms. It is used in making of rifle stock and butt, turnery, carving, sports tools, musical instruments and marquetry. Root sections are used to obtain boards with diverse appearance.



Walnut FJ A
Solidwood Panel

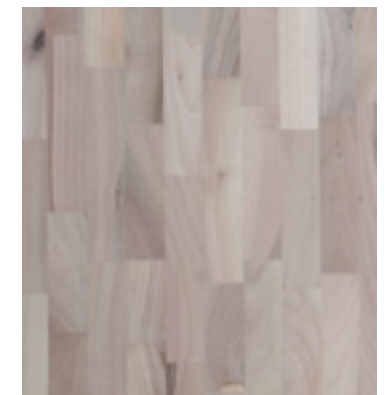

Walnut FJ B
Solidwood Panel

Timber

Our timbers are produced in our production facility with modern machinery at international standards by processing the logs obtained from the forests that are at the end of their life cycles, reducing humidity levels to 10-12% through air-drying and state of art technology automated kilns. We are meeting demands of furniture and construction industry with our rich raw material resources and timber variety produced from Beech, Oak, Elm, Pine, Spruce, Fir as well as exotic trees such as Iroko, Sapele, Ayous, Okume.

Our timbers are in edged and unedged form.

Our timbers are produced with or without edges. All timbers are measured and cubed after kiln-drying process.

We are capable of meeting your custom size timber and log needs quickly with our customer-oriented service principle.

TECHNICAL PROPERTIES

Thickness (mm): 50-60-80-100

Width (mm): 100 mm and above

Length (mm): 2.000 mm and above

Kiln Dried: % 10-12 moisture

Air Dried: % 25-30 moisture

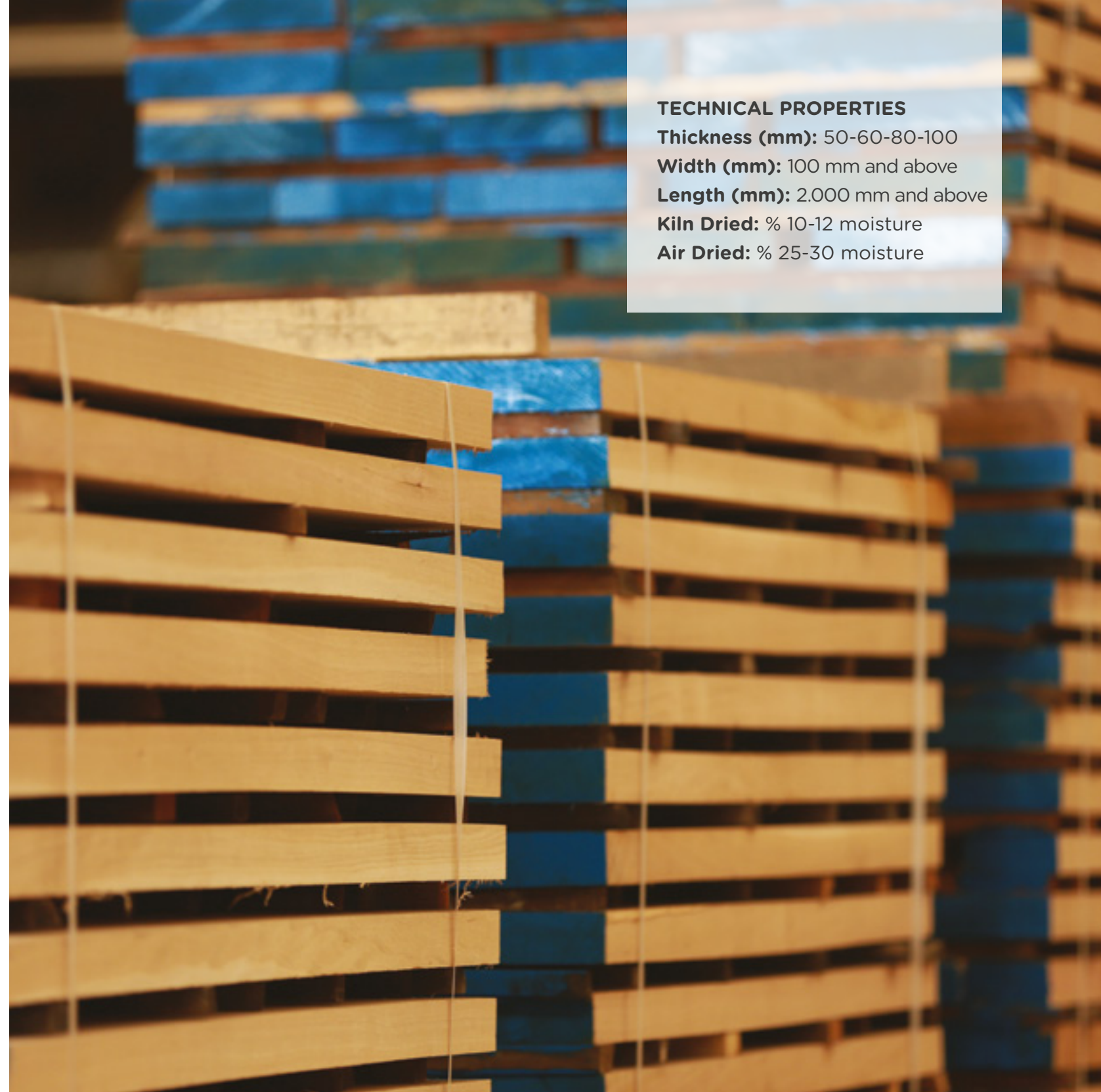

Wooden Railway Sleeper

Railway sleepers are made of hard, good quality, healthy trees with dense and straight fibers. All the trees used in sleeper production are cut while green before the feed water reaches the tree. Sleepers are in straight and regular form. End plates are assembled on both ends of the sleepers. Our sleepers are subjected to impregnation process with ecological creosote under high pressure against pest infestation and decaying. Impregnation process extends service life of oak sleepers for approximately 30 years. Our sleepers are produced in accordance with EN 13145 standards as adzed and unadzed, impregnated using ecological creosote.

Areas of Use

Wooden sleepers which last many years even exposed to the most severe climate conditions are now also being used in park and garden decorations besides railways. In addition to their robustness, their easy removal and transportation, usability as both wall and stairs make them indispensable element of parks and gardens. Wooden sleepers are easy to maintain and low-cost.



TECHNICAL PROPERTIES

- Track Sleepers (mm):**
160x260x2.600
- Switch Sleepers (mm):**
160x260x2.600-5.500
- Bridge Sleepers (mm):**
260x280/ 300x300x2.600
- Types of Trees:**
Oak, Beech, Azobe, Larex
- Custom size available

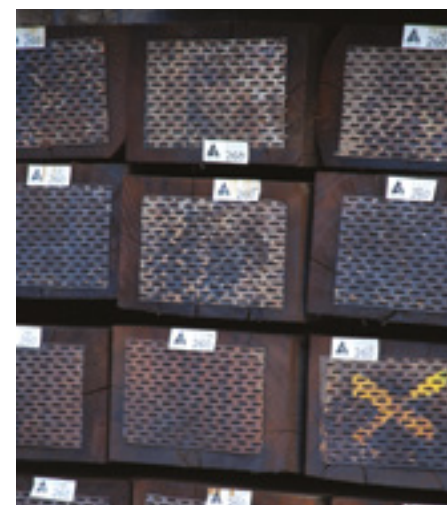

T&G Flooring

Solid wood flooring is a doweled wood flooring used at indoor spaces. Tree species that are resistant against surface pressure and wearing are preferred for solid wood flooring. Solid wood flooring requires more manpower compared to laminated parquets, aiming to offer combination of luxury and elegance. Manual work requisite instead of automated technology makes this product unique.

Areas of Use

Used as floor covering at home, office and sport halls.

Properties

- Long lasting.
- Provides sound and thermal insulation.
- It can be scraped and polished, therefore offers a long life cycle.
- It doesn't lead to respiratory or allergy problems.
- Easy to maintain and clean.
- The most suitable floor furnishing for children as it is made of natural wood.

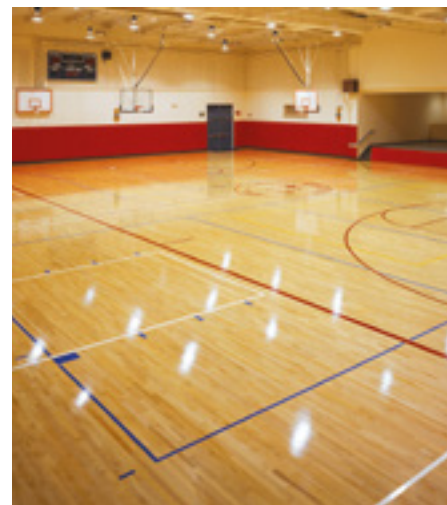

TECHNICAL PROPERTIES

Thickness (mm): 15-19

Width (mm): 80-90 ve 130-150

Length (mm): 300-1.300 ve 400-3.000

Types of Tree: Oak, Beech

Custom sizes available

Laminated Parquet

It is a 100% natural product formed by solid wood layers. Layers are adhered to each other in 90 degrees angle. Top layer is produced as a natural solid coating while bottom surface is produced in layers of birch marine plywood. The surface is either polished or oiled, and ready to apply. It does not require scraping or polishing after initial furnishing but it can be scraped multiple times just like solid hardwood floor. Laminated parquet floor is a quality, long lasting and natural furnishing material. This product is capable of meeting preferences of all users, and strays from traditional floor furnishings as they come out of packing as polished and ready for use. Thus, laminated parquets can be quickly furnished.

Areas of Use

Used as floor covering at home, office, hotel and restaurant.

Properties

- They are long lasting.
- Provide sound and thermal insulation.
- Suitable for scraping and polishing, therefore they can be used for many years.
- It does not lead to respiratory or allergy problems.
- Easy to maintain and clean.
- They are made of natural wood and are the most suitable floor furnishing for children.

TECHNICAL PROPERTIES

Thickness (mm): 14-16

Width (mm): 80-90-125-145-165-195

Length (mm): 1.000-3.000

Types of Tree: Oak, Beech, Iroko, Sapele, Walnut

Custom sizes available

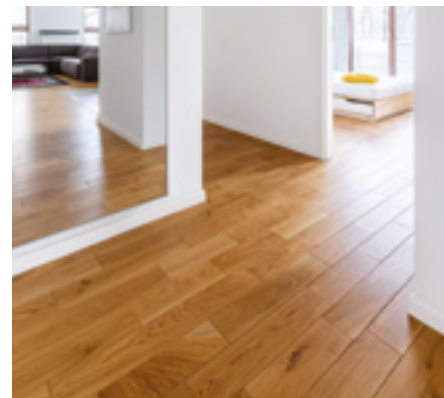
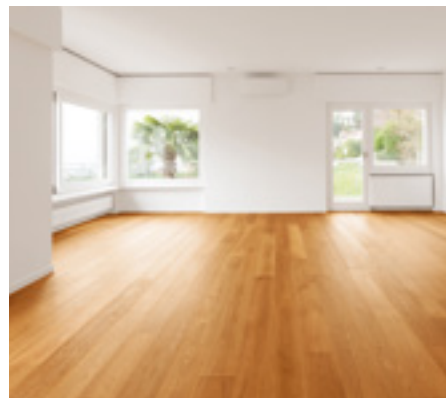

Decking

Deck is a wooden material made by processing trees resistant to outdoor conditions such as Oak, Teak, Iroko, Merbau, Ipe which are dried in special kilns at our plant and cut in free size or in various sizes in the form of tiles as a modular system for outdoor use.



Areas of Use

Deck is used on the edges of pools, terraces, pergola, balcony, sauna, beach, walkways, ship boards, yacht production and exterior facade applications. Mesh layer placed underneath deck material allows quick and efficient draining of water. Deck material is mounted on the mesh using galvanized steel screws. Decking modular system is another method that can be applied on mesh and as tiles which can be removed and transported to be used elsewhere or to be stored for further use.

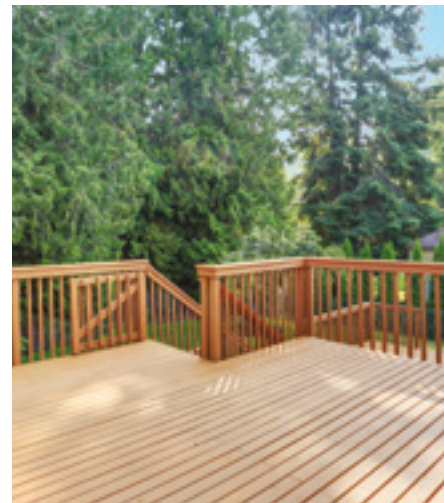

TECHNICAL PROPERTIES
Thickness (mm): 18-22
Width (mm): 90-120
Length (mm): 900 mm above

Wainscot

Wainscot is a type of furnishing/ decoration obtained by placing and joining woods side by side. Pine, cedar, and African origin trees are used for wainscot production. Larex, Burmex Teak, Iroko, Sapele are widely preferred tree species for wainscot.

Areas of Use

It is used as wall-ceiling coating material at indoor spaces, terraces and balconies, etc.

TECHNICAL PROPERTIES

Thickness (mm): 16-19-22

Width (mm): 80-90-125

Length (mm): 1.000-4.000

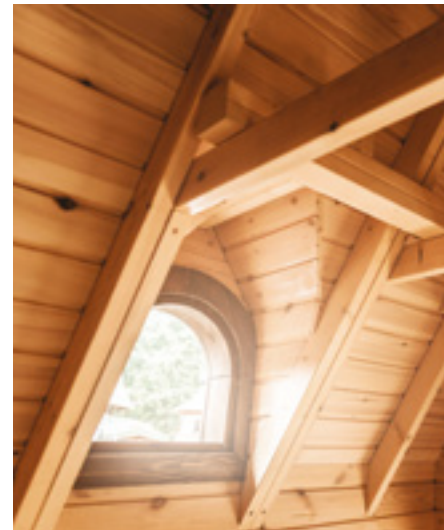

Osب

It is made by compacting of several long, thin chips in 3 layers, oriented in right angle. OSB is produced from high quality, needle-leaved trees growing in our country such as pine. The chips made of those trees are carefully dried and compacted under high pressure and heat with synthetic resin and paraffin emulsion. OSBs, besides offering superior technical specifications thanks to extremely careful production process, they also maintain all natural properties of wood.

Areas of Use

They are used as wall coating and partition walls in wooden structures, and the most significant use of OSB is as the base layer for shingle roof coating.

TECHNICAL PROPERTIES
Thickness (mm): 09-11-15-18
Width (mm): 1.220
Length (mm): 2.440



Plywood

It is produced by adhering flakes obtained by peeling of trees with their fibers in transverse orientation and pressing into sheets under high temperature and pressure. It is widely used for its high robustness, superior mechanical properties and high capacity of holding nails and screws as well as no potential of shrinking or swelling, ease of processing and decorativeness. We are mainly producing film coated (plywood) and uncoated boards from poplar, beech and birch trees.

Areas of Use

They are mostly used as molding material in construction business and also in production of furniture, billboard panels, wall partitions, armchairs, chairs and school desks.

TECHNICAL PROPERTIES
Thickness (mm):
From 3mm to 30mm
WidthxLength (mm):
2.200x1.700-2.200x1.300
2.100x1.700-2.100x1.300
2.500x1.250-2.500x1.300
2.440x1.220
Custom sizes available

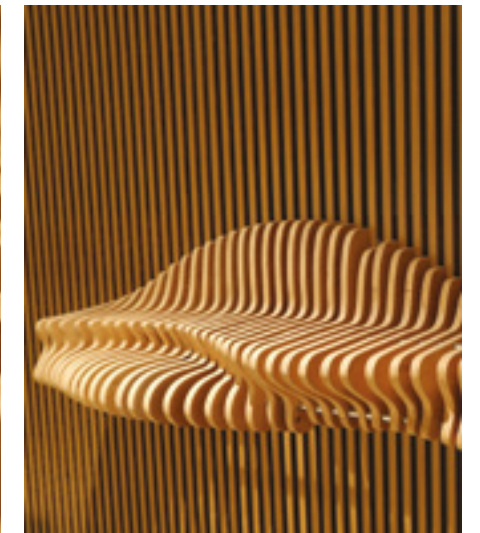

Laminated Beams

The woods are stabilized by reducing their moisture content to 12% (± 2) and then produced in required dimensions and joined using certified adhesives. These linear wooden structure materials are then produced in max. 150 mm x 1.300 mm x 6.000 mm dimensions in cold lamination press machine.

Areas of Use

- Structural elements for high loads and wide spaces
- Bridges, towers and similar special structures
- Sports halls, concert halls, factories and warehouse buildings
- Columns and furnishing beams in houses and commercial structures

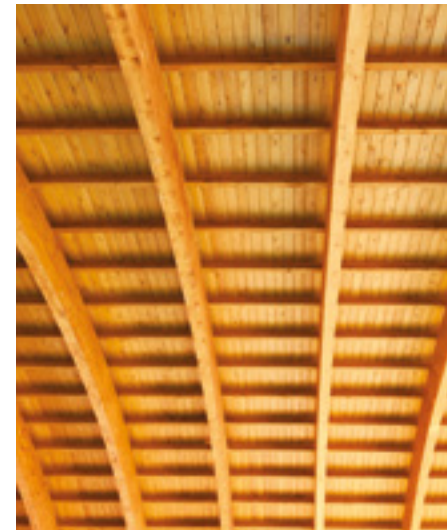
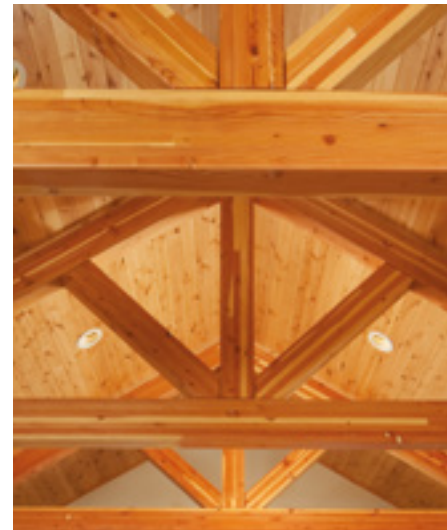

Wooden Profile

Solid Wooden Profiles are produced using state of the art technology machinery, providing custom solutions where needed; using trees such as Sapele, Sipo, Oak, Iroko, Afrormosia, Pine, Larex and Walnut. During production, imported or domestic timbers are subjected to drying process in computerized kilns depending on location of use. After completing impregnation and lamination procedures, they are produced in state of art technology computerized machinery from desired trees, painted using special imported water-proof but air-permeable paint that allows ventilation of the place, also protecting the woods against outdoor climate conditions, then polished and assembled.



Our Stores in Turkey

İstanbul İkitelli 1

İ.O.S.B. Keresteciler Sitesi 19. Sok. 20. Blok
No: 22-24 Başakşehir / İSTANBUL
ikitelli1@salkimorman.com.tr

İstanbul İkitelli 2

İ.O.S.B. Keresteciler Sitesi 21. Sok. 22. Blok
No: 18-24 İkitelli - Başakşehir / İSTANBUL
ikitelli2@salkimorman.com.tr

İstanbul Dudullu

Altınşehir Mah. Nato Yolu Cad. No: 90-A
Yukarı Dudullu - Ümraniye / İSTANBUL
dudullu@salkimorman.com.tr

Ankara

Ulubay Mah. Taşdelen Cad. No: 24
Siteler - Altındağ / ANKARA
ankara@salkimorman.com.tr

Antalya

Şafak Mah. Akdeniz Sanayi Sitesi
Ahşap İşleri Bölümü 5024 Sokak No: 9
Kepez / ANTALYA
antalya@salkimorman.com.tr

İzmir

Cennetoğlu Mah. Yeşillik Cad. No: 218
35380 Karabağlar / İZMİR
izmir@salkimorman.com.tr

Adana

Güzelevler Mah. Keresteciler Sitesi
Meşe Cad. No: 72 Yüreğir / ADANA
adana@salkimorman.com.tr

Konya

Horozlu Han Mah. Ağaç İşleri
Sanayi Sitesi Hotamış Sok. No: 24
Selçuklu / KONYA
konya@salkimorman.com.tr

Bursa

Üçevler Mah. Küçük Sanayi Sitesi
35. Sok. 64. Blok No: 9-11
Nilüfer / BURSA
bursa@salkimorman.com.tr

Şanlıurfa

Kadıkendi Mah. Yeni Mobilyacılar Sitesi
08746 Cad. No: 1/G
Eyyübiye / ŞANLIURFA
sanliurfa@salkimorman.com.tr

Gaziantep

Sanayi Mah. 60016 Nolu Cad. No: 60
Şehitkamil / GAZİANTEP
gaziantep@salkimorman.com.tr

Samsun

İstiklal Mah. Suoğlu Cad. No: 19/1
Tekkeköy / SAMSUN
samsun@salkimorman.com.tr

Diyarbakır

Bağcılar Mah. 1254. Sok.
S.S. Metal İşleri Yapı Sitesi E Blok No: 17 E/10
Bağlar / DİYARBAKIR
diyarbakir@salkimorman.com.tr

